

ALL INFORMATION CONTAINED HEREIN IS THE PROPERTY OF SPRINGLINE ARCHITECTS L.L.C. THE CONCEPTS, IDEAS, DESIGNS AND DETAILS AS SHOWN ON THE DOCUMENTS WERE CREATED, DEVELOPED, AND PRESENTED FOR USE ON THIS SPECIFIC PROJECT AND SHALL NOT BE REUSED FOR ANY PURPOSE WHATSOEVER WITHOUT THE WRITTEN CONSENT OF SPRINGLINE ARCHITECTS L.L.C. THE OWNER SHALL BE PERMITTED TO RETAIN COPIES FOR INFORMATION AND REFERENCE PURPOSES ONLY.

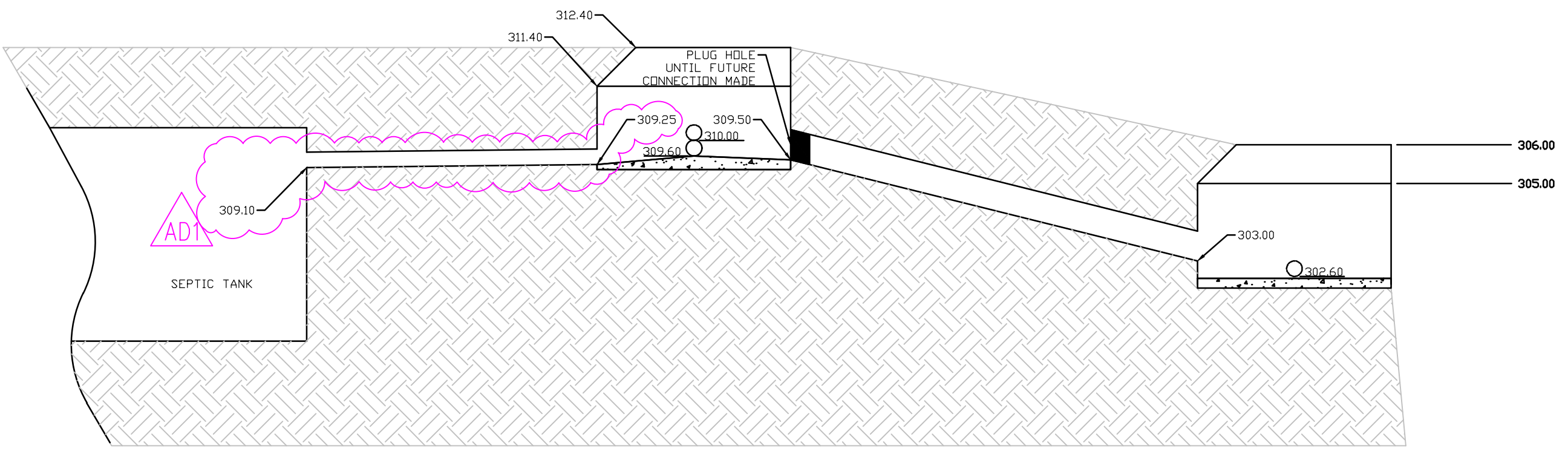
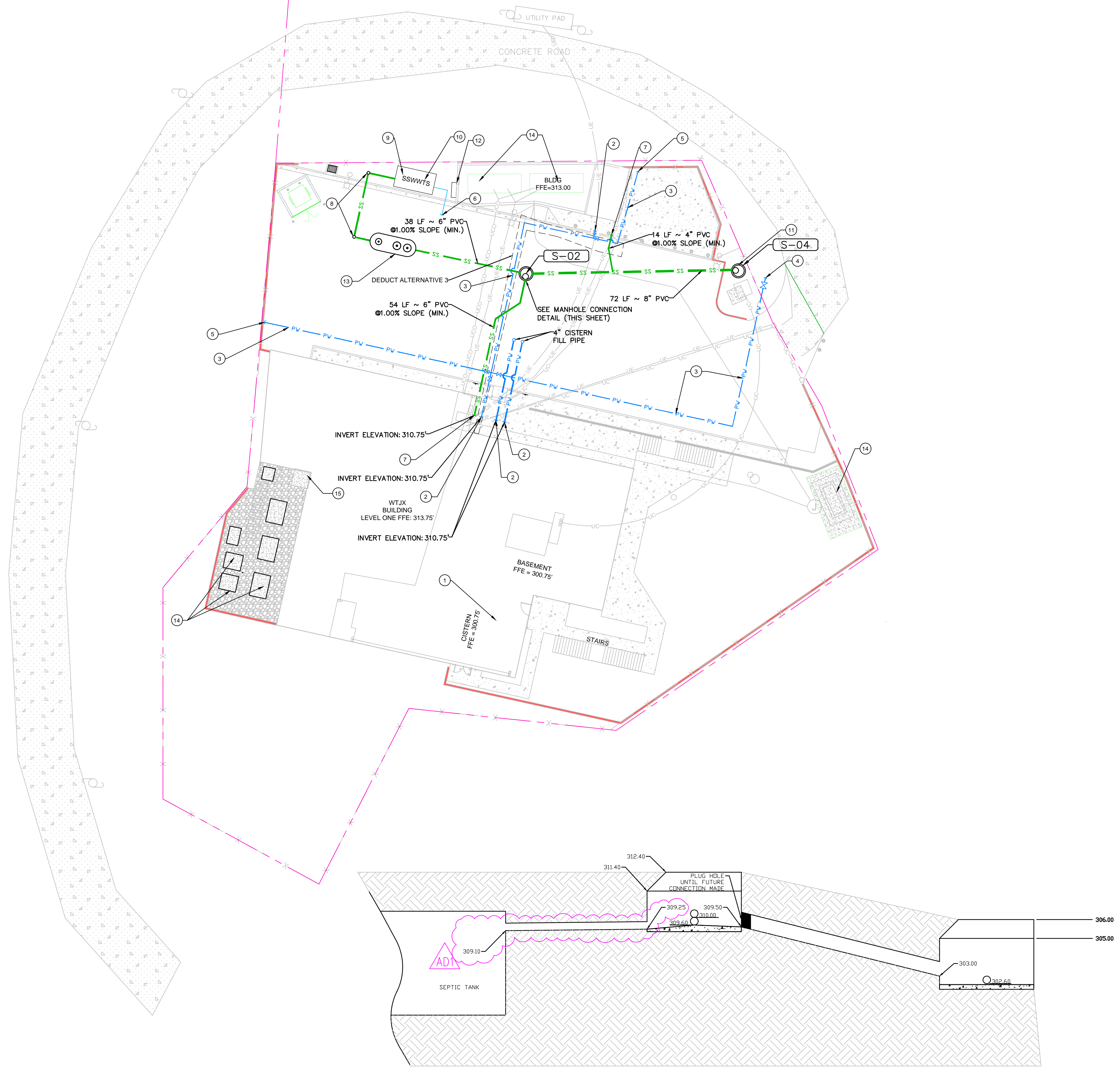

- UTILITY LEGEND**
- PW POTABLE WATER PIPE
 - RW REUSE WATER PIPE
 - SS SANITARY SEWER GRAVITY PIPE
 - DEDUCT ALTERNATIVE
- UTILITY KEY DATA**
- CISTERNS & PUMP STATIONS (WITHIN BASEMENT) (REFER TO PLUMBING PLANS)
 - POTABLE WATER BUILDING POINT OF CONNECTION (REFER TO PLUMBING PLANS FOR CONTINUATION)
 - 1.5" POTABLE WATER PIPE
 - FUTURE WAPA POTABLE WATER POINT OF CONNECTION
 - HOSE BIBB POINT OF CONNECTION
 - REUSE WATER SYSTEM POINT OF CONNECTION (COORDINATE WITH LANDSCAPE IRRIGATION LOCATION)
 - SANITARY SEWER BUILDING POINT OF CONNECTION (REFER TO PLUMBING PLANS FOR CONTINUATION)
 - SANITARY SEWER CLEANOUT
 - SANITARY SEWER PRIMARY TREATMENT (RECESSED)
 - SANITARY SEWER TERTIARY TREATMENT (RECESSED)
 - FUTURE WMA SANITARY SEWER POINT OF CONNECTION
 - WASTE WATER TREATMENT PLANT CONTROL PANEL W/ SHADING FOR SUN PROTECTION
 - BELOW GROUND TWO COMPARTMENT FIBERGLASS SEPTIC TANK W/ TRAFFIC RATED ACCESS RISERS
 - ELECTRICAL/MECHANICAL EQUIPMENT & FOUNDATION (REFER TO ELECTRICAL/MECHANICAL DRAWINGS)
 - ANTENNA & FOUNDATION (REFER TO MECHANICAL PLANS)
- UTILITY NOTE:**
- ELECTRICAL SHOWN FOR REFERENCE CONTRACTOR TO REFER TO ELECTRICAL DRAWINGS FOR DESIGN AND DETAILS.
 - UTILITIES TO MAINTAIN A MINIMUM OF 3' COVER UNLESS OTHERWISE NOTED.

SANITARY SEWER STRUCTURE TABLE:

MANHOLE	MANHOLE
S-02 SANITARY SEWER MANHOLE RIM=312.40' IE=309.25 (NW) IE=309.50 (SE) (PLUGGED) IE=310.20 (SW) N5338.89 E8103.03	S-04 SANITARY SEWER MANHOLE RIM=306.00 IE=303.00 (NW) N5341.74 E8179.60

- DEDUCT ALTERNATIVES:**
- SEE NOTES PAGE

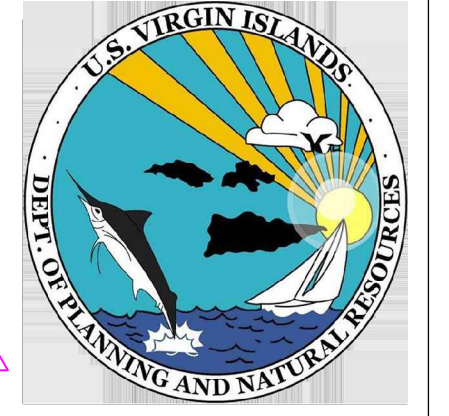
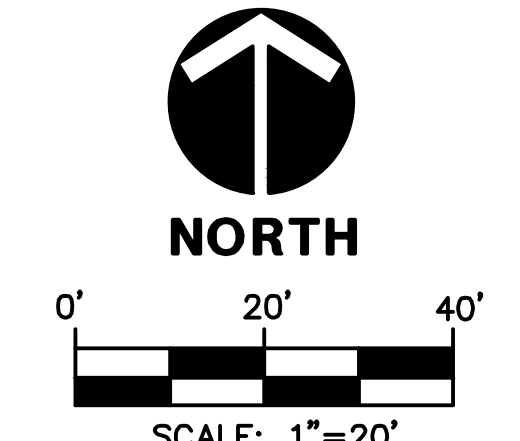

HARRIS CIVIL ENGINEERS

1200 Hillcrest Street, Suite 200
Orlando, Florida 32803
Phone: (407) 629-4777
Fax: (407) 629-7888
www.harriscivilengineers.com
EB 9814

WTJX Broadcasting Facility
Haypiece Hill, Parcels 158A and 158 Rem
Submarine base, St. Thomas USVI

UTILITY PLAN

REVISIONS:

No.	Description	Date
1	ADDENDUM	03/07/25

DRAWN BY: CT
CHECKED BY: NDW
DATE: APRIL 26, 2024

HCE JOB NUMBER
06162036

SHEET NUMBER
C3.00